

Temple Beth Emeth
Religious and
Hebrew School

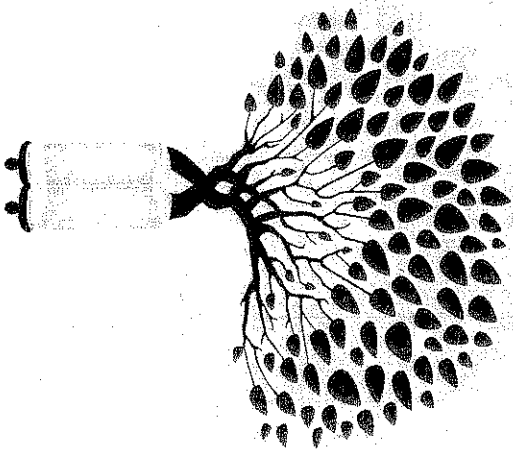

The Year of Torah

תּוֹרָה

Parent Handbook

5772

2011 - 2012

*Welcome to TBE
Religious & Hebrew School*

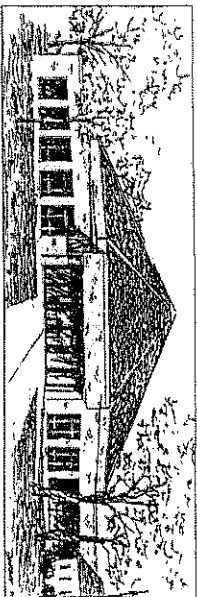

דוּנְאָן דוּנְאָנאָ

First Days of School

Religious School begins on

Saturday, September 10 and Sunday, September 11

Hebrew School begins on

Monday, September 19 / Wednesday, September 21

New Parent Orientation: Saturday, September 10

8:50–9:10am in the Adult Lounge
or 11:00–11:20am in the Chapel

School Times for 2011/12

Saturday First Session:

8:30 -10:15

Saturday Second Session:

10:45 -12:30

Sunday: 6:00 -7:30

Monday and Wednesday Hebrew : 4:15-6:00

תַּבֵּן אֶסְתֵּר
AND YOU SHALL TEACH THEM DILIGENTLY

Temple Beth Emeth Religious and Hebrew School educates our students to become life-long Jewish learners within the framework of a vibrant Jewish community.

We provide students with curriculum based on Reform Jewish educational philosophy in a manner that is creative, engaging and intellectually stimulating. We employ enthusiastic teachers who are knowledgeable and deeply committed to Judaism.

We acknowledge and are grateful for the commitment and involvement shown by the families of our students.

Table of Contents

TBE School Mission Statement	1
Table of Contents	2
The First Day of School	3
The Basics: TBE Educational Program	4
Religious School Overview	4
Hebrew School Overview	5
Youth Choir Program	5
Temple Beth Emeth Classroom Map	6
Attendance	7
Tzedakah	7
Parent Communication	8
Chaverweb	8
Library	8
Family Education	9
Code of Behavior	9
Snow Emergency Days	10
Curbside Traffic Procedure	11
Curriculum Overview (Pre-School 3 - 12th Grade)	12
Fees & Scholarships	15

This handbook outlines our school policies and important school information.

PLEASE KEEP THIS HANDBOOK AS A REFERENCE
THROUGHOUT THE SCHOOL YEAR!

Contact Information

Director of Education:

Terri Ginsburg, 665-5817

tginsburg@templebethemeth.org

Assistant Principal, Saturdays, Madrichim Coordinator

Viki Shayna, 665-5817

vsheyana@templebethemeth.org

Religious School Assistant:

Sarah Krell, 665-5817

skrell@templebethemeth.org

Temple Beth Emeth Office:

734-665-4744

The First Day of School

These procedures are very important to ensure a smooth beginning to our school year!

- 1) Review the TBE Traffic & Parking procedures!
- 2) Class placements will be mailed to you before school begins. Class lists will also be posted on the lower level bulletin board on the first day of school.
- 3) Parents should accompany children for the first few minutes of class if they are attending Religious School for the first time or are in Pre-School, Kindergarten or First Grade.
- 4) At dismissal, students wait for rides at the circle driveway. They MUST wait until their ride pulls to the curb between the safety cones & are **NOT** permitted to cross the driveway.
- 5) All Preschool 4 parents and parents of any child needing assistance getting secure in the car **must come into the classroom to pick up their children.**

We are serious about our commitment to parking lot safety!

The Basics: TBE Education Program

Temple Beth Emeth offers quality Judaic education for children ages 3 through 18. Classes are held in our building from September to April, with private tutoring available in the summer.

TBE offers a Reform Jewish education that will provide the religious & cultural background necessary for your child's ongoing participation in Jewish life.

Religious School

The objective of the TBE Religious School is to educate students about Jewish history, holidays, ethics & traditions while offering a positive cultural experience. Our program is sensitive to the needs of children of interfaith families.

Lower School (Preschool - 5th Grades)

Religious School meets Saturday mornings in 2 sessions.

First Session ~ 8:30 to 10:15 am

Second Session ~ 10:45 am to 12:30 pm

Rabbi Levy leads a 15-minute service at the beginning or end of each session, then students divide into classes by grade.

Curricula for younger children includes: Jewish holidays, Israel, Prayers, Bible stories, Israeli dance, Songs & Jewish customs. Curricula for older students includes: Jewish history, Current events, Bible, Prayers, Ethics, Israel, Jewish identity, Reform Judaism and the life cycle.

Upper School (6th - 12th Grades)

Upper school meets Sunday evenings from ~ 6 - 7:30 pm

The students enjoy studying in a relaxed atmosphere where pizza and pop is served at the beginning of each class.

Students in 11th & 12th grades may choose to take one or both exciting one-semester seminars on Sunday evenings at TBE.

Madrichim Program (9th-12th Grades)

Ninth graders can participate in monthly training sessions preparing them to work as teacher assistants or office aides in our school. 10th-12th grade Madrichim are paid classroom assistants. They enrich our school by providing teachers with extra help and serving as role models for younger students.

The Basics: TBE Education Program

Hebrew School

The objective of the TBE Hebrew School is to educate students to participate more fully in Jewish life as well as prepare them for the B'nai Mitzvah experience. Students are instructed in written & spoken Hebrew language & prayers. Hebrew School meets once per week from 4:15 p.m. to 6:00 p.m. on Monday or Wednesday. Students divide into grade specific classrooms in order to study Hebrew. **Weekly Hebrew homework assignments** are an integral part of our Hebrew School program.

Bar/Bat Mitzvah Tutoring

Approximately one year before the bar/bat mitzvah date, Cantor Annie Rose will meet with the student and parents to give the student his/her portion and materials and provide information about private b'nai mitzvah tutoring in Ann Arbor. The family then contacts a tutor and sets up a schedule for tutoring. Over the course of study with the tutor, all students will have several appointments with Cantor Rose and Rabbi Levy or Rabbi Deison.

Youth Choir Programs

The TBE Youth Choir consists of 3rd to 5th grade students, and performs throughout the year at TBE & in the community. Choir rehearsals are held during Hebrew School on Mondays & Wednesdays from 5:40-6:00 p.m. All students interested in **singing** and playing **percussion instruments** are encouraged to join!

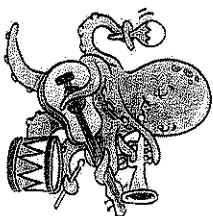

Shir Chadash consists of vocal & instrumental ensembles, one for middle school students and the other for high school students. **Middle School Shir Chadash rehearses on Sundays from 5:00-6:00** (1 hour before school starts). **High School Shir Chadash rehearses on Sundays from 7:30-8:30** (1 hour after school ends). Shir Chadash also performs throughout the year both at TBE & in the community. Opportunities exist for solo instrumental & vocal performances. Both singers & instrumentalists are encouraged to join!

Please contact Cantor Annie Rose for more information on our Music Programs.



TBE Classroom Layout

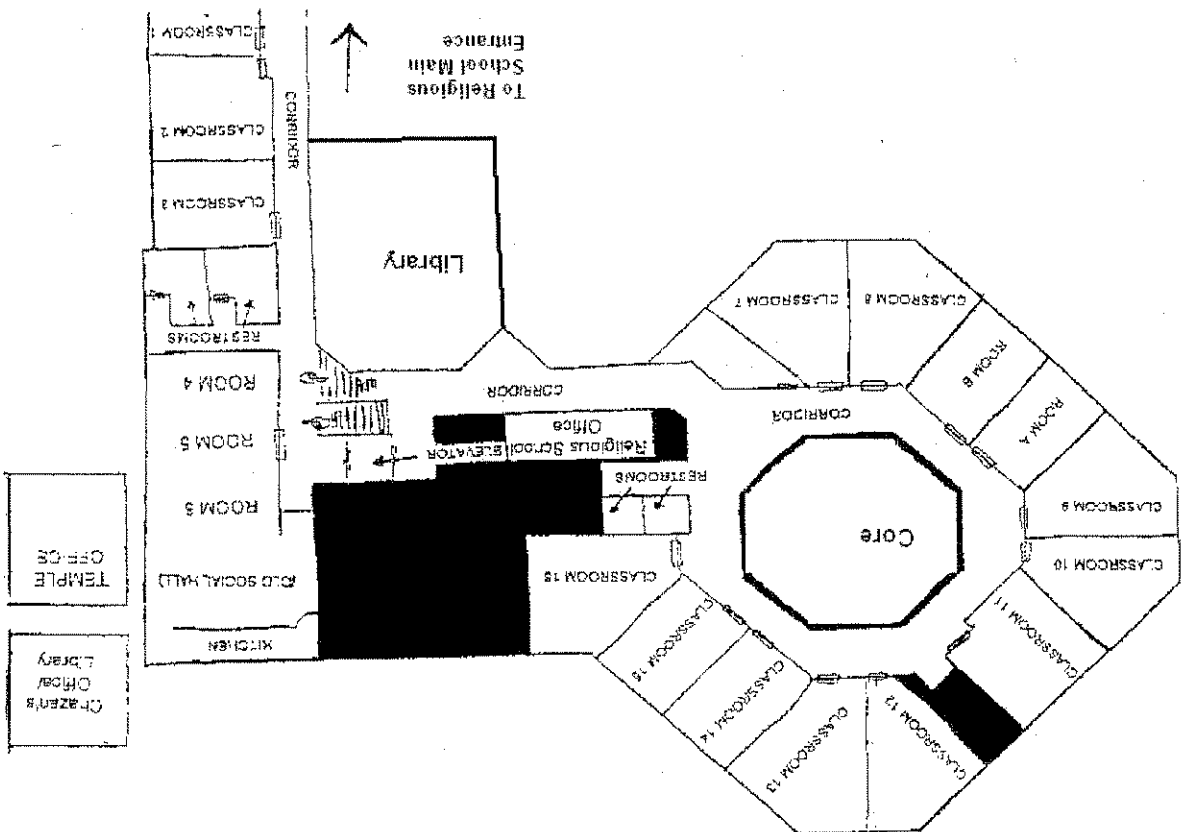

Parent Handbook

Attendance

Building Jewish community within our school requires **REGULAR ATTENDANCE**. We want all of our students to benefit from both the educational & social aspects of our program. Regular attendance is required for participation in Jewish Lifecycle events (Consecration, B'nai Mitzvah, Confirmation). If attendance falls below 75%, the Director of Education will contact the family. In the event of extended illness or other extenuating circumstances, parents should contact the teacher & the Director of Education. When appropriate, make-up work will be arranged.

Tzedakah



The Hebrew word "Tzedakah" means "justice" and refers to deeds ranging from donating money to performing acts of charity. Tzedakah is a central value of Judaism and of our educational program.

Students are encouraged to bring in money each week to contribute to tzedakah.

Students suggest or are offered a choice of organizations who will receive their tzedakah donation. Throughout our school program students study about the value of tzedakah in Judaism and the many forms it can take.

Each year our pooled dimes, quarters and dollars add up into the thousands of dollars, which we then donate toward Tikun Olam (healing the world)!

"You shall open your hand wide to your brother, to your poor and to your needy"
... *Deuteronomy*

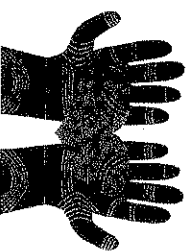

Parent Communication

Parents are central to their child's Jewish education. We encourage parents to visit throughout the year. Please notify the teacher or office in advance of your visit.

Teachers write formal report cards twice per year and are available by phone or after school for conversations. You will receive your teacher's email address. Feel free to contact them at any time. Conferences are arranged upon request.

Chaverweb— Up-to-Date & In-the-Know

Chaverweb is TBE's new on-line member database! You should have already received a username & password, but if you need one, contact Soohi Min, TBE Executive Director.

Up-to-Date: Chaverweb allows you to view contact and emergency information for every member of your family. Please keep information current, so the school can contact you about up-coming events, school cancellations, or in an emergency.

In-the-Know: Chaverweb will be the place to sign-up for Temple events including family programs, field trips, workshops, meals, etc!

Keep your username and password posted so all family members can log-on! Access the database by going to the TBE's website, clicking on members only, and access member database. You can bookmark the page to get to it quickly in the future!

Library

The library is an integral part of the Religious School curriculum, used both by teachers and students. We have computers with Internet access and Judaic programs. Even the youngest children can use the computers. Our computer programs range in level from preschool through adult. Additionally, we have a Judaic Video Collection with over 200 titles and many new Jewish & Israeli DVDs. Your child's class will be scheduled for visits to the library approximately once per month. Please note that books have a two week loan period. You can call to renew at 665-4744 x 237. Please come in to browse during Hebrew or Religious School.

Family Education

Each year in grades Pre-School 4 - 5th grade, there is a Family Program. These vary in theme and type of activity. PS4 and Kindergarten have a special program during their Religious School session.

First Grade families attend a Shabbat dinner before Consecration.

Second Grade families travel to "Shalom Street", a Jewish Children's Museum in West Bloomfield.

Third, Fourth and Fifth Grade families participate in programs designed to have parents and students learn together.

Sixth Grade students & parents participate in two B'nai Mitzvah workshops in the fall & lead services in February.

Seventh Grade families enjoy the B'nai Mitzvah Fiesta.

Tenth Grade students & parents participate in several programs during their teen's Confirmation year.

Jewish Parenting Workshops are offered during the year.

Code of Behavior

We hope to create an environment in our school which is safe, conducive to learning and reflects Jewish values. The children are expected to treat each other, their teachers and Temple property with respect.

Behavioral expectations and rules will be discussed and made clear in each classroom at the beginning of the school year. If a student is having difficulty maintaining appropriate behavior during class, the teacher will give the student two warnings. If the negative behavior continues, the students will be sent to the office to meet with the Director of Education.

The Director of Education will meet with the student to discuss the situation and possible solutions. The child will either return to class or be given class work to complete in the office. If the situation does not improve, parents will be notified and possibly asked to meet with the teacher, student and/or the Director of Education.

Snow Emergency Days

Michigan weather is notorious. Inevitably there will be days of inclement weather when school will be canceled. If school is canceled, the following set of procedures should inform everyone who is enrolled.



Religious School

For school cancellations see our website
(www.templebethemeth.org)

Check your email! We will send an email to the parent email addresses we have on file when school is cancelled.

There will be a message recorded on the school phone.

734-665-5817

Hebrew School

If there is inclement weather on a Hebrew School day, we will make a decision about canceling by noon, and send out an email to the address of the primary parent. We will also announce the closing on our website. There may be days that the public schools have canceled school, but Hebrew School will meet if the roads are clear.

We encourage you to call TBE Religious School at

665-5817 or check the Temple website at

www.templebethemeth.org

~ anytime you think school might be canceled.

Curbside Traffic Safety

Students will be dismissed from the doors closest to the Social Hall each Saturday, Sunday, Monday & Wednesday. Teachers will walk younger students to their cars. Saturday school students may enter through the wooden doors closest to the Social Hall only.

FOR EVERYONE'S SAFETY AND CONVENIENCE DRIVERS MUST ADHERE TO THE FOLLOWING TRAFFIC PATTERN AND CURBSIDE PROCEDURE

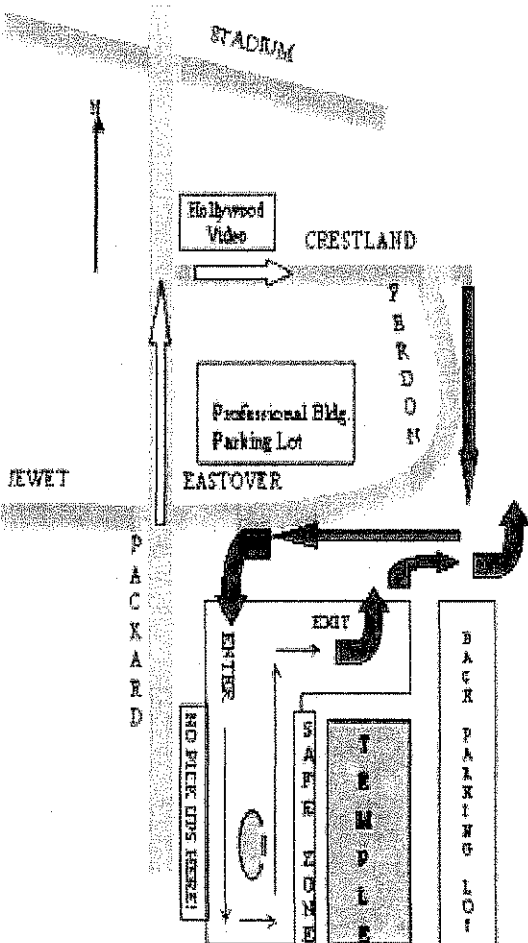

- ALL PRESCHOOL 4 PARENTS AND ANY PARENTS WHO MUST FASTEN A CHILD INTO A CARSEAT MUST COME TO THE CLASSROOM TO PICK UP THEIR CHILD.
- **DO NOT** turn onto Eastover from Packard. **INSTEAD, turn onto CRESTLAND**, one block **NORTH** of Eastover by HOLLYWOOD VIDEO.
- Turn **RIGHT** onto FERDON, then follow the curve which becomes Eastover.
- Turn **LEFT** into the TBE Circle Drive. (You will be heading West)
- Pick up children **ONLY** when you are **STOPPED AT THE CURB** & you are **between the orange cones Pickup Zone**.
- **PLEASE DO NOT ATTEMPT TO PICK UP FROM THE INSIDE LANE.**
- To exit turn **RIGHT ONLY** onto Eastover & proceed along FERDON.
- **DO NOT** TURN LEFT onto Eastover or cut across the street to parking lot. **Make sure your children AND ANYONE PICKING THEM UP for you, know these procedures! Be aware of and patient with TBE visitors and guests who do not know our traffic flow pattern.**
- **IF YOU WANT TO PARK** on Saturdays, use the Professional Building Lot across from TBE off of Eastover and walk over to the pick up area.

Curriculum Overview

- ♦ *You must be a member of TBE to enroll your child in Religious or Hebrew School.*
- ♦ Pre-School 3—5th Grade enjoy a short music class each session.
- ♦ We have our own holiday curriculum that focuses on different aspects of the Jewish holidays at each grade level.
- ♦ Attendance at Hebrew School and Religious School is required for all Bar /Bat Mitzvah candidates. Hebrew is an important skill for all students.

Grades PS3-5 Religious School meet Saturday mornings

- Pre-School 3**
 - Parent & Child monthly program designed to allow the parent & child to experience Judaism with a focus on home holiday observance.

- Pre-School 4**
 - Holiday Symbols & Shabbat
 - Jewish Music & Stories

- Kindergarten**
 - Bible Stories (Creation through Moses)
 - Holiday Symbols & Celebration
 - Jewish music & stories

- First Grade**
 - Consecration
 - Introduction to Tzedakah & Mitzvot
 - Bible Stories (Moses through Jonah)
 - Jewish Holidays

- Second Grade**
 - Introduction to Hebrew Alphabet
 - Jewish Symbols and Ritual Objects
 - The Synagogue: the Place, the People, the Symbols
 - Torah: Its Creation, Its Parts, Its Importance
 - Jewish Holidays
 - Trip to *Shalom Street Jewish Children's Museum* in West Bloomfield.

Curriculum Overview

- Third Grade**
 - Israel: Land and People
 - Torah Study
 - Jewish Holidays
 - **Hebrew School** begins with the basic Aleph-Bet, beginning reading, writing & prayers.

- Fourth Grade**
 - Jewish Calendar
 - Prophets, Judges, and Kings
 - Jewish Holidays
 - **Hebrew**- reading fluency, cursive writing, prayers & some conversational skills

- Fifth Grade**
 - Jewish Heroes: Challenges and Choices Our Leaders Made from Ancient Babylonia to Modern Israel
 - Tzedakah (Mitzvah heroes & class mitzvah project)
 - Jewish Identity
 - **Hebrew**- reading fluency, prayer vocabulary development and understanding, some conversational skills.

Grades 6-12 Religious School meet Sunday evenings

- Sixth Grade**
 - Jewish Life Cycle & Jewish Ethics
 - Weekly Torah Portion
 - **Bar/Bat Mitzvah Parent & Child Education** (2 sessions)
 - **Hebrew**- review prayers, lead standard Shabbat services, study Torah service in depth, and gain some conversational skills.

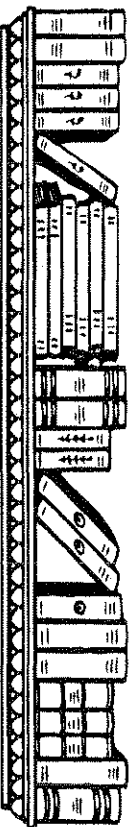

Curriculum Overview

Seventh Grade

- Study of Mitzvot
- Hands-on Social Service Projects
- Hebrew - B'nai Mitzvah Preparation

Eighth Grade

- Modern Jewish History, Life in Eastern Europe, Ashkenazic & Sephardic Cultures, Immigration to America & Jewish Life in America
- Trip to "Jewish New York" in the Spring
- **Conversational Hebrew** offered on Monday afternoons

Ninth Grade

- Ethical Dilemmas: A Jewish Perspective
- Jewish Artistic Responses to the Holocaust
 - Trip to Holocaust Memorial in West Bloomfield
- Israel - Modern History
- **Madrichim** (Classroom Aide) Training Program (once a month)

Tenth Grade - Confirmation

- Taught by Rabbi Levy & Rabbi Delson
- Spirituality & Kabbalah
- Liturgy & Writing a Service
- Confirmation Dinner and Service

11th-12th Grade Seminars

- Class meets Sunday 6-7:30
- "From Singer to Spielberg: Expressions of Jewish Identity" (first semester)
- "Jews on the Edge: Exploring Radical Jewish Culture" (second semester)

Madrichim

- Classroom and office aid opportunities

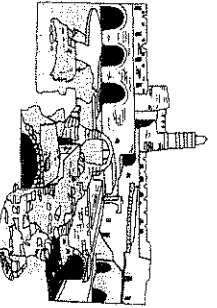

Fees and Scholarships

Tuition is charged on a yearly basis. Fees are set separately for Religious School and Hebrew School. These fees are subsidized by the Temple and include the cost of books. Be sure to take home your child's textbooks at the end of the year to enrich your home library!

Fee Schedule - Religious School

- Preschool 3 (Saturday, meets monthly) \$150
 - Preschool 4 - 5th Grade (Saturday) \$350
 - 6th Grade - 12th Grade (Sunday) \$380 *
- *This amount includes a pizza and pop fee for the year.

Fee Schedule - Hebrew School

3rd Grade - 8th Grade \$360

*Scholarships are available by request to:
Terri Ginsburg, Director of Education
tginsburg@templebethemeth.org.*

Regular attendance is required for eligibility for scholarships.

Notes.....

Notes.....

2011-2012 JEWISH & LEGAL HOLIDAYS

** Jewish Holidays begin the evening before the date listed.*

September 5, 2011	Labor Day
September 29, 2011	Rosh Hashanah
October 8, 2011	Yom Kippur
October 13, 2011	Sukkot
October 20, 2011	Simchat Torah
November 24, 2011	Thanksgiving
December 20, 2011	First Night of Chanukah
January 1, 2012	New Year's Day
January 16, 2012	Martin Luther King Day
February 8, 2012	Tu B'Shevat
March 8, 2012	Purim
April 7, 2012	Pesach (Passover)
April 26, 2012	Yom Haatzma'ut
May 27, 2012	Shavuot
May 28, 2012	Memorial Day

Temple Beth Emeth

The Year of Torah

הַתּוֹרָה

Parent Handbook

5772

Temple Beth Emeth Religious & Hebrew School
2309 Packard Street
Ann Arbor, Michigan 48104
Phone: (734) 665-5817
Fax: (734) 665-9237

Terri Ginsburg, Director of Education
Wiki Shayna, Assistant Principal, Saturdays
Sarah Krell, Religious School Assistant
Email: tginsburg, vshayna or skrell@templebethemeth.org

Web site: www.templebethemeth.org/section/school
School wiki: tbeschoolwiki.wikispaces.com